

# Introducing *ULTRASTAR* by **STARCRAFT**

**Bus & Mobility**

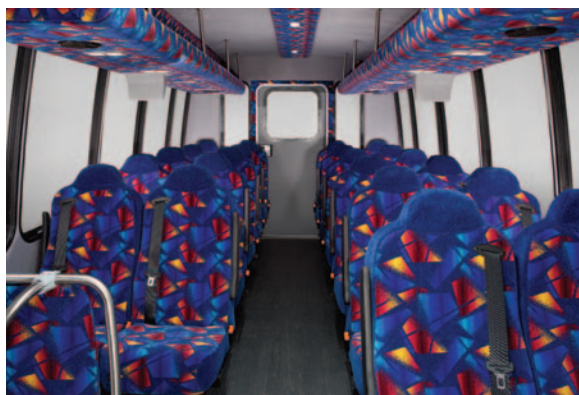

The elegant, upscale *ULTRASTAR* ... Luxurious enough for the opera; rugged enough for the parking lot.



The luxurious *ULTRASTAR* interior shown features optional level 6 seating with matching parcel rack, center accent panel and rear door trim fabric, optional 3 point seat belts, and all rubber floor.

- **LARGE 42" HIGH SOLID GLASS WINDOWS PROVIDE PANORAMIC VIEWS FOR PASSENGERS**
- **UNDERSTATED STYLING DETAILS APPEAL TO SOPHISTICATED CLIENTELE**
- **MAINTENANCE FREE FIBERGLASS FASCIA PANELS INCLUDE FRONT AND REAR CAPS, RUNNING BOARDS, SKIRTS, TRANSITIONS AND WHEEL WELL TRIM**
- **ATTRACTIVE, OEM STYLE DOOR MOUNT MIRRORS**
- **EXTERIOR MARKER/RUNNING/STOP/TURN LAMPS ARE L.E.D. AND RECESSED FOR MAXIMUM LIFE**
- **RUGGED ALL STEEL CAGE PROVIDES SAFETY**
- **AVAILABLE EXCLUSIVELY ON FORD DUAL DOOR CHASSIS IN 158", 176" AND 190" WHEEL BASE**
- **OEM STYLE EXTERIOR MIRRORS ENHANCE STYLING**



Optional rear door with window and twin side glass shown.



The road side view reveals the elegant lines and expansive glass on the *ULTRASTAR*. Such styling and attention to detail attract discriminating clients.

Your discriminating clientele demands distinctive styling and luxurious features, and you require rugged construction and high value. The *ULTRASTAR* combines both opulent styling and sturdy welded steel cage construction to fulfill all your needs. Whether you transport clients to the ballet, on tours to shopping malls or casinos, executives to various sites, church or senior groups to functions, or parking operation services, the luxurious, rugged *ULTRASTAR* meets all your needs in one good looking, jig welded steel cage package. Available in a variety of seating and luggage configurations, *ULTRASTAR* also offers features like DVD/VCP equipment with multiple monitors, PA systems for tour hosts, and fully ADA compliant lift and passenger solutions. The all-new *ULTRASTAR* combining all you want and everything you need.

**VISIT YOUR LOCAL STARCRAFT DEALER TODAY TO LEARN MORE ABOUT THE EXCITING, LUXURIOUS, VALUE PACKED *ULTRASTAR* !!**

## **STARCRAFT**

**Bus & Mobility**

Div. of Forest River, Inc.

2703 College Ave. ■ P.O. Box 838 ■ Goshen, IN 46527 ■ 800-348-7440 x 486 ■ Fax: 574-533-6850 ■ [www.starcraftbus.com](http://www.starcraftbus.com)

## STANDARD EXTERIOR FEATURES

- ONE -PIECE SEAMLESS FRP ROOF
- ELEGANT, FLOWING BODY CONTOURS
- FULL JIG WELDED STEEL SAFETY CAGE
- 42" HIGH SOLID TINTED GLASS PASSENGER GLAZING
- CORROSION-FREE FIBERGLASS FRONT/REAR CAPS, RUNNING BOARDS, SKIRTING AND WHEELWELL MOLDING
- L.E.D. EXTERIOR TURN/STOP AND MARKER LAMPS
- RECESSED EXTERIOR LIGHTING FOR PROTECTION
- OEM STYLE BREAKAWAY EXTERIOR MIRRORS ON DOORS
- REAR MUD FLAPS
- HEAVY DUTY STEEL REAR BUMPER - WHITE
- AVAILABLE ON DUAL DOOR CAB ONLY
- ELECTRIC ENTRY DOOR WITH FULL VIEW GLASS AND ALUMINUM FRAME FOR EACH LEAF
- REAR EGRESS WINDOW
- MODULAR ELECTRICAL PANEL CIRCUITRY
- ATTRACTIVE VEHICLE GRAPHICS PACKAGE
- EXHAUST EXTENSION TO REAR OF VEHICLE

## STANDARD INTERIOR FEATURES

- OEM CHASSIS AM/FM/CD STEREO, POWER WINDOWS AND DOOR LOCKS, DRIVER AND COPILOT SEATS WITH CHOICE OF UPHOLSTERING
- ATTRACTIVE GREY, AUTOMOTIVE QUALITY CLOTH SIDEWALL, REAR WALL AND CEILING
- DOOR ACTIVATED PASSENGER COURTESY LIGHTING
- GREY RIBBED RUBBER AISLE
- GREY COMMERCIAL GRADE CARPET UNDER SEATS
- RADIUSED MODESTY PANEL AT ENTRY DOOR
- RED LIGHTS AT ALL EMERGENCY EXIT WINDOWS
- HIGH DENSITY, NON-HYGROSCOPIC SIDEWALL AND CEILING INSULATION

## POPULAR OPTIONAL FEATURES

- ALL RUBBER FLOOR WITH COVE MOLDING TO SIDEWALL (ALSO AVAILABLE IN COLORS)
- OVERHEAD PARCEL AND/OR REAR LUGGAGE
- DUAL AIRCONDITIONING UP TO 93,000 BTU
- AUDIO VISUAL SYSTEMS WITH DVD/VCP PA AND MULTIPLE MONITORS (REQUIRES PARCEL RACKS)
- PARCEL RACK AND CENTER CEILING STRIPE UPHOLSTERED WITH MATCHING SEAT FABRIC
- CUSTOM GRAPHICS AND/OR PAINT, INCLUDING WINDOW BLACK OUT (SHOWN ON BROCHURES)
- DESTINATION SIGNS (MOTORIZED OR ELECTRONIC)
- STAINLESS STEEL WHEEL INSERTS (SHOWN)
- FULLY ADA COMPLIANT LIFT PACKAGE OPTIONS



Flowing body lines and luxurious interiors appeal to the discriminating clients.



Whether your needs call for an elegant night out on the town, or the full time demands of round the clock shuttle service, the all new *ULTRASTAR* from Starcraft fits the bill. By combining a tough steel welded cage frame with head-turning design and lavish styling, the bridges a long standing gap between affordable transportation and executive livery service. You can now offer your clients the luxury they want in a rugged vehicle you need.

*ULTRASTAR* — THE  
EVERYTHING YOU  
EVER NEEDED BUS.



FLOORPLAN



FLOORPLAN

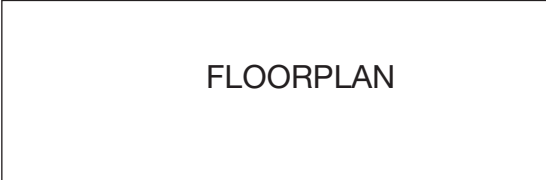

FLOORPLAN

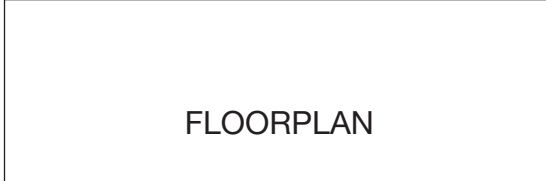

FLOORPLAN



FLOORPLAN

**STARCRAFT**

**Bus & Mobility**  
Div. of Forest River, Inc.